

i-sink 95 DX

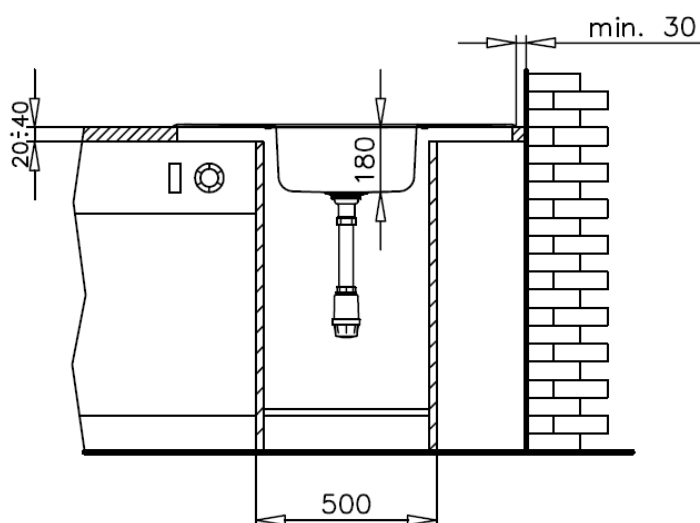
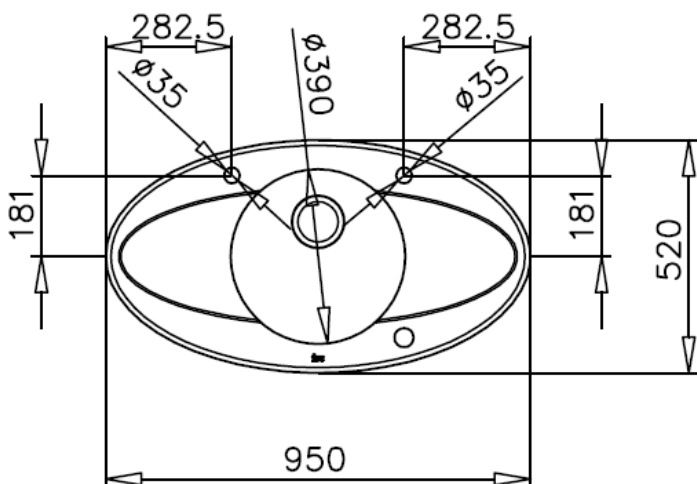

FEATURES

- Tempered glass top: 8 mm thickness
- Stainless steel bowl: 0,8 mm thickness
- External dimensions: 950 x 520 mm
- Bowl dimensions: Ø390 x 180 mm
- Base units: 50 cm
- Packaging: individual box

• Included:

- High spout tap
- Touch control for tap (on/off, temperature & flow control)
- CPU control box
- Pop-up 3 1/2" basket waste & Overflow
- Connections & siphon
- Installation instructions

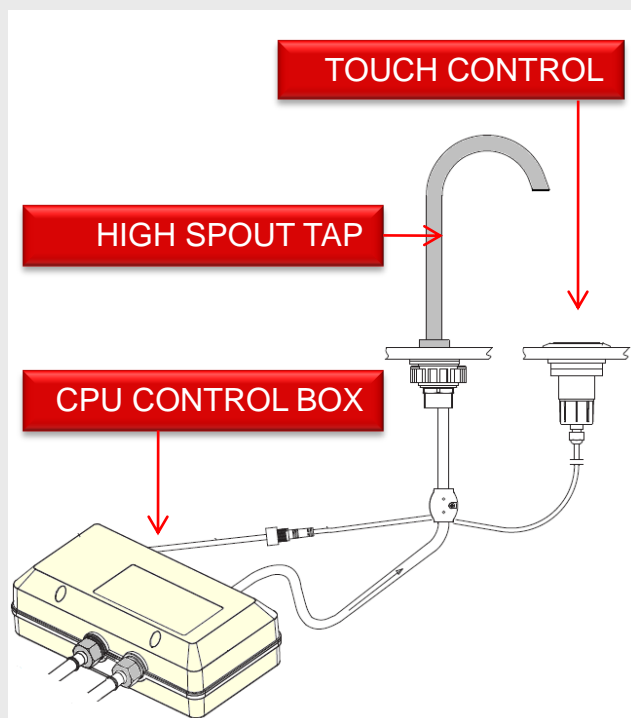

Code: 13129009

EAN: 8421152090329