

BASICO ø510 1B

FEATURES

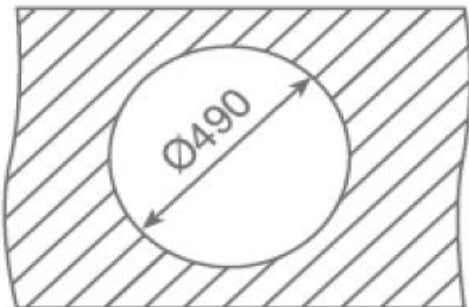
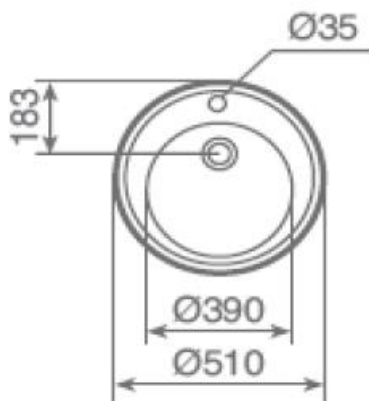

- Unpolished (BA) / MICROTTEXTURATED
- Thickness: 0,6 mm.
- 3 ½ " valve hole
- With overflow
- Bowl dimensions: ø390 mm.
- Bowl depth: 160 mm.
- External dimensions: ø510 mm.
- Base units: 45 cms.
  
- Packaging: Cardboard protector and pallet

- Accessories included:

Box of 6 installation clips



Sealing strip



| Code     | Description                             |
|----------|---|
| 10124021 | BASICO Ø510 1B GT W/OVF (BA) (PAL/CART) |